

Medtronic

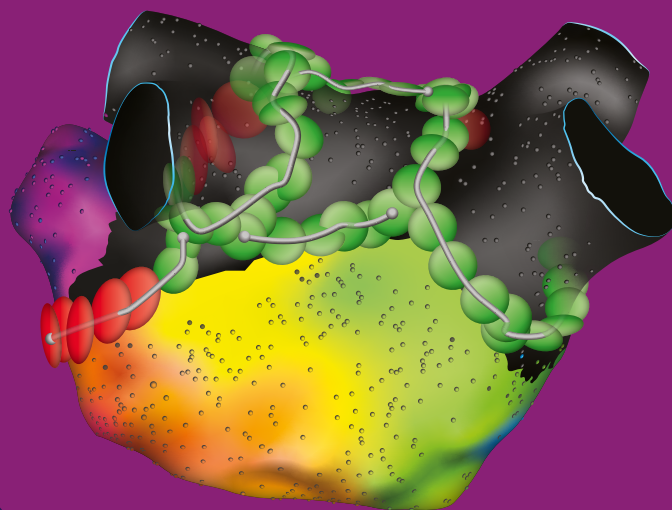

Success Simplified

Affera[™] mapping and ablation system

Intuitive mapping. Refined insights. Streamlined workflows.

Affera mapping and ablation system

Experience a new paradigm in EP

The Affera mapping and ablation system is a fully integrated solution offering more predictable and flexible procedures¹ while empowering physicians to accurately map and safely² ablate **using an all-in-one, HD mapping and dual energy (PF and RF) catheter** through a single transeptal access **with a zero exchange workflow.**¹

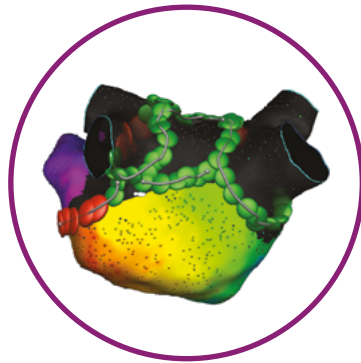

Affera™ Prism-2
mapping software

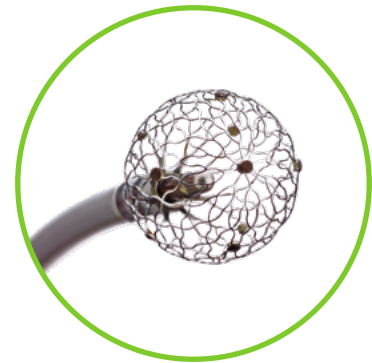

Sphere-9™
catheter



HexaGen™ RF generator

Temperature-controlled RF energy delivery

HexaPulse™ PF generator

Unipolar, biphasic PF energy delivery

HexaMap™ catheter interface unit (CIU)

Magnetic and impedance navigation and map acquisition with intracardiac electrogram and electrocardiogram display, recording, and pacing

HexaFlow™ irrigation pump

Responsive, automated irrigation and bubble detection

Affera Prism-2 mapping software

Intuitive mapping

Efficient, high-fidelity mapping

Quickly generate high-fidelity, realistic anatomy to enable identification of ablation targets.

Synergy navigation

Hybrid impedance and magnetic mapping modalities for visualization of sensor-based and non-sensor-based catheters.

Vein Mode

Designed to delineate complex regions of the heart, which may reduce the use of fluoroscopy.^{1,3}

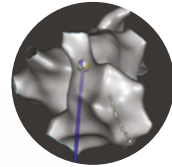

CS catheter visualization

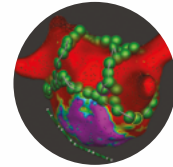

Zero-fluoro procedure post-map

Refined insights

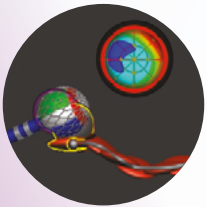

Automatic tags

Instant insights about tip location, orientation, and lesion creation

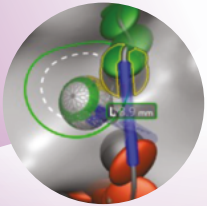

AfferaConnect™ line

Visually confirm ablation groups and lesion set contiguity

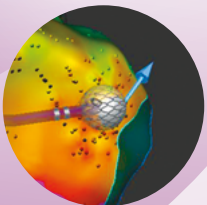

Propagation arrow

Assess wavefront directionality for every beat before, during, and after ablation

Sensor globe

Real-time mapping and ablation guide with tissue temperature display during RF and PF delivery

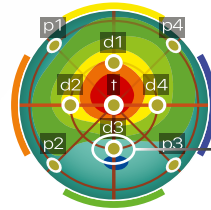

Real-time local impedance

Real-time local impedance providing tissue proximity feedback

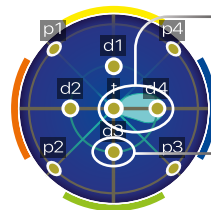

PF Signature™ software

Visualize physiologic response of PF energy delivery to the tissue

Streamlined workflows

Integrated stimulator

Validate lesion sets using exclusive pacing modes and expedite differential pacing workflows

Low- or zero-fluoro workflows

Minimize fluoroscopy time with synergy navigation

Seamless dual-energy modality transition

Easily and quickly transition between energy sources to deliver safe¹, durable² lesions

Efficient lab setup

Simplify lab and procedure preparation with direct 12-lead signal acquisition

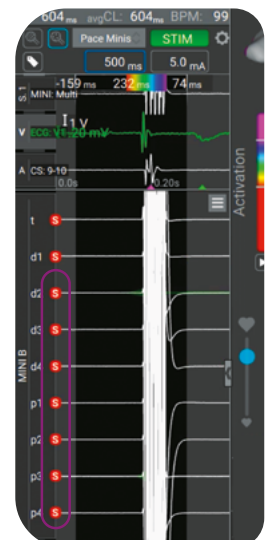

Sphere-9 catheter

Map. Ablate. Validate.

Map

Close-Unipolar™ mapping combines the benefits of bipolar and unipolar electrogram acquisition⁴ using **nine mini surface electrodes** and **one central reference electrode**.



11
minutes²

5,000
points²

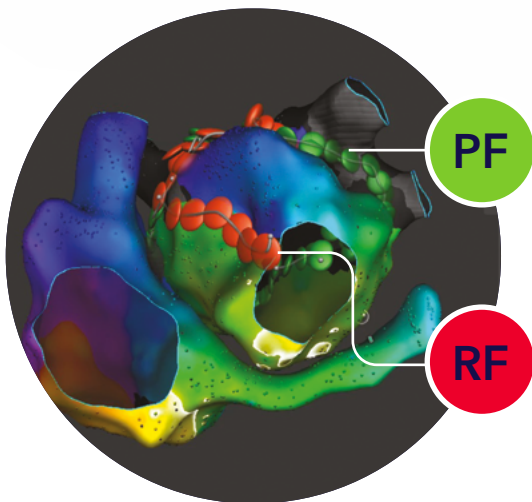

Ablate

Indicated for persistent AFib and typical flutter using RF energy, **the compressible, 9 mm ablation electrode lattice tip** creates lesions in less time using fewer wide area focal lesions.^{5,6}

Safe,¹ effective,¹ and durable²
PF and RF lesions

10x Larger surface area compared to standard irrigated ablation catheters^{5,7}

97% Per-vein durability at 3 months (Pulse3 waveform)²

Validate

Transition from ablation to validation using a **single transeptal access and zero exchange workflow¹** with **8 Fr bidirectional catheter** design.

Confirm electrical conduction block with ease using **exclusive pace modes** specifically designed for the Sphere-9 catheter.

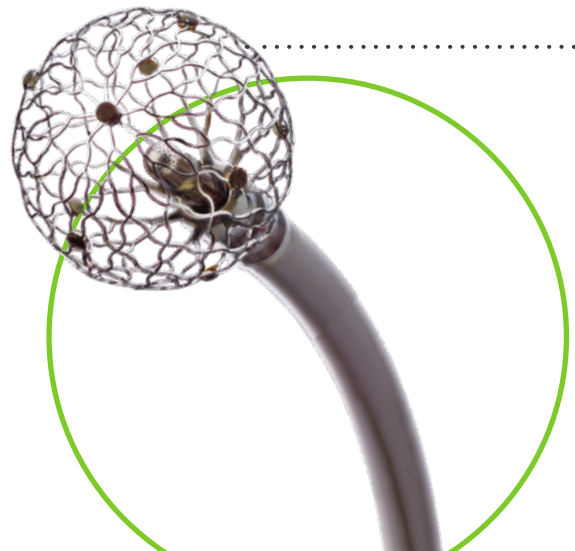

SPHERE Per-AF IDE¹

First and only randomized 1:1 persistent AF clinical trial

→ **Sphere-9 catheter**
with Affera mapping and ablation system | n = 212

→ **THERMOCOOL SMARTTOUCH™* SF (STSF)**
with CARTO™* mapping system | n = 208

Approaching superior effectiveness[†]



Proven safety[‡]



Primary safety event rate

- 0 PV stenosis
- 0 Phrenic nerve paralysis
- 0 Cardiac tamponade
- 0 Atrio-esophageal fistula

The highest **effectiveness** of any IDE treating a persistent population

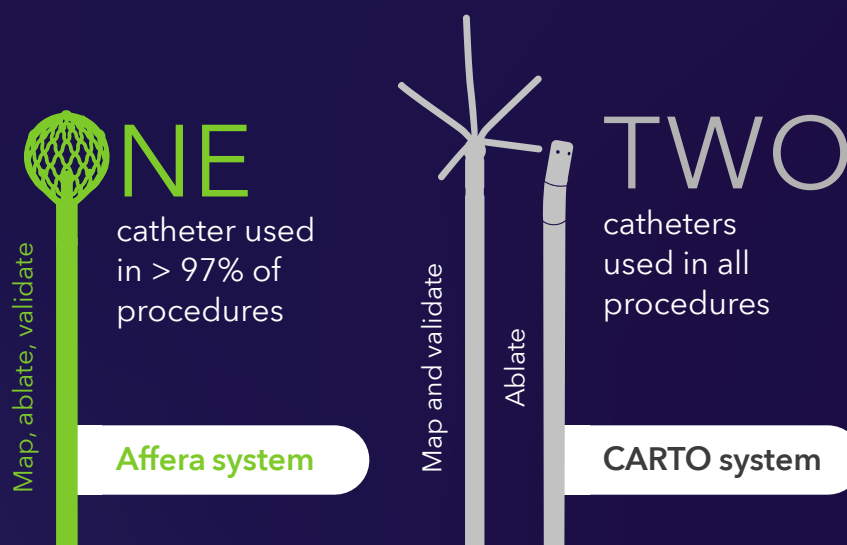

Superior procedural efficiency over STSF



[†] Primary effectiveness endpoint definition: The primary effectiveness endpoint was acute procedure failure, repeat ablation at any time, or after three months: recurrence of AF/AFL/AT, cardioversion, or new/reinitiated/increased AAD usage.

[‡] Total of 13 adverse events measured, resulted in 3 hospitalizations within 1-week post- procedure for COPD exacerbation, pulmonary edema, and hemoptysis.

For a full list of safety events, review the SPHERE Per-AF manuscript.

1. Anter E, Mansour M, Nair DG, et al. Dual-energy lattice-tip ablation system for persistent atrial fibrillation: a randomized trial. *Nat Med*. August 2024;30(8):2303-2310.
2. Reddy VY, Anter E, Rackauskas G, et al. Lattice-Tip Focal Ablation Catheter That Toggles Between Radiofrequency and Pulsed Field Energy to Treat Atrial Fibrillation: A First-in-Human Trial. *Circ Arrhythm Electrophysiol*. June 2020;13(6):e008718.
3. M060056C001, Affera Prism-2 Mapping Software Manual. July 22, 2025.
4. de Bakker JM. Electrogram recording and analyzing techniques to optimize selection of target sites for ablation of cardiac arrhythmias. *Pacing Clin Electrophysiol*. December 2019;42(12):1503-1516.
5. Anter E, Neužil P, Rackauskas G, et al. A Lattice-Tip Temperature-Controlled Radiofrequency Ablation Catheter for Wide Thermal Lesions: First-in-Human Experience With Atrial Fibrillation. *JACC Clin Electrophysiol*. May 2020;6(5):507-519.
6. Barkagan M, Leshem E, Rottmann M, Sroubek J, Shapira-Daniels A, Anter E. Expandable Lattice Electrode Ablation Catheter: A Novel Radiofrequency Platform Allowing High Current at Low Density for Rapid, Titratable, and Durable Lesions. *Circ Arrhythm Electrophysiol*. April 2019;12(4):e007090.
7. Reddy VY, Peichl P, Anter E, et al. Atrial Fibrillation Using a Focal Lattice-tip Catheter that Toggles Between Pulsed Field and Radiofrequency Energy: Effect on the Esophagus. *Heart Rhythm*. August 2021;18(S8):S73.
8. Nair D. Operator Learning Curve with a Novel Dual-Energy Lattice-Tip Ablation System. Presented at: APHRS 2024; September 28, 2024; Sydney, Australia.

This material should not be considered the exclusive source of information, it does not replace or supersede information contained in the device manual(s).

Please note that the intended use of a product may vary depending on geographical approvals.

See the device manual(s) for detailed information regarding the intended use, the (implant) procedure, indications, contraindications, warnings, precautions, and potential adverse events.

For a MRI compatible device(s), consult the MRI information in the device manual(s) before performing a MRI.

If a device is eligible for eIFU usage, instructions for use can be found at Medtronic's website manuals.medtronic.com.

Manuals can be viewed using a current version of any major internet browser. For best results, use Adobe Acrobat® Reader with the browser.

Medtronic products placed on European markets comply with EU and UK legislation (if applicable) on medical devices.

For any further information, contact your local Medtronic representative and/or consult Medtronic's websites.

Medtronic

Europe

Medtronic International Trading Sàrl.
Route du Molliau 31
Case postale
CH-1131 Tolochenaz
www.medtronic.eu
Tel: +41 (0)21 802 70 00
Fax: +41 (0)21 802 79 00

20624329-en-gb-emea © 2025 Medtronic. Medtronic, Medtronic logo, and Engineering the extraordinary are trademarks of Medtronic. All other brands are trademarks of a Medtronic company.